



Design Working Group Meeting #2

November 30, 2017

Justice Implementation Task Force

Agenda

1. **Introduction (10 minutes)**
 - a. **Where we are and goals of the meeting**
 - b. **RFP for master plan for borough-based jail system**
2. Presentation: best practices in facilities design (40 minutes)
3. Discussion (35 minutes)
4. Closing and next steps (5 minutes)

RFP for master plan for borough-based jail system

Project Scope Overview

- Investigation and assessment of three existing DOC facilities (Manhattan, Brooklyn, Queens) to determine how to expand or reconstruct.
- Identification and investigation of additional sites, with a focus on neighborhood integration and fair share analysis.
- Study will culminate in a master plan for the phasing out of existing facilities and operations on Rikers Island that aligns with a Master Plan for standing up a borough based jail system with a capacity to house 5,000 people.

RFP for master plan for borough-based jail system

Key Project Considerations

- Study shall include robust community engagement, including meetings, surveys and workshops with neighborhood residents, facility staff, city agency staff, providers, attorneys, and formerly incarcerated individuals and their families.
- Consultants shall use design principles consistent with minimum NYS-SCOC and NYC-BOC Standard for Design Guidelines, and other design principles recommended by the Design Working Group of the Justice Implementation Task Force.

Projected Timeline

- Q1 2018 – Identify consultant and register contract
- Q4 2018 – complete study

Agenda

1. Introduction (10 minutes)
2. **Presentation: best practices in facilities design (40 minutes)**
 - a. **Case studies and key takeaways**
 - b. **Justice in Design process and findings**
3. Discussion (35 minutes)
4. Closing and next steps (5 minutes)

CHICAGO METROPOLITAN CORRECTIONAL CENTER

- 27 Stories
- Self contained modules of 44 people
- Centralized double height common area
- Direct supervision from central guard station

Challenges of High Rise Detention Facilities

- Dependent on elevators
- Limitation on outdoor activities
- Intimidating/overwhelming for staff and detainees

Welcoming Civic Spaces and Buildings

- Higher civic trust
- Greater trust in government and civic pride
- Perception of building as welcoming and inclusive

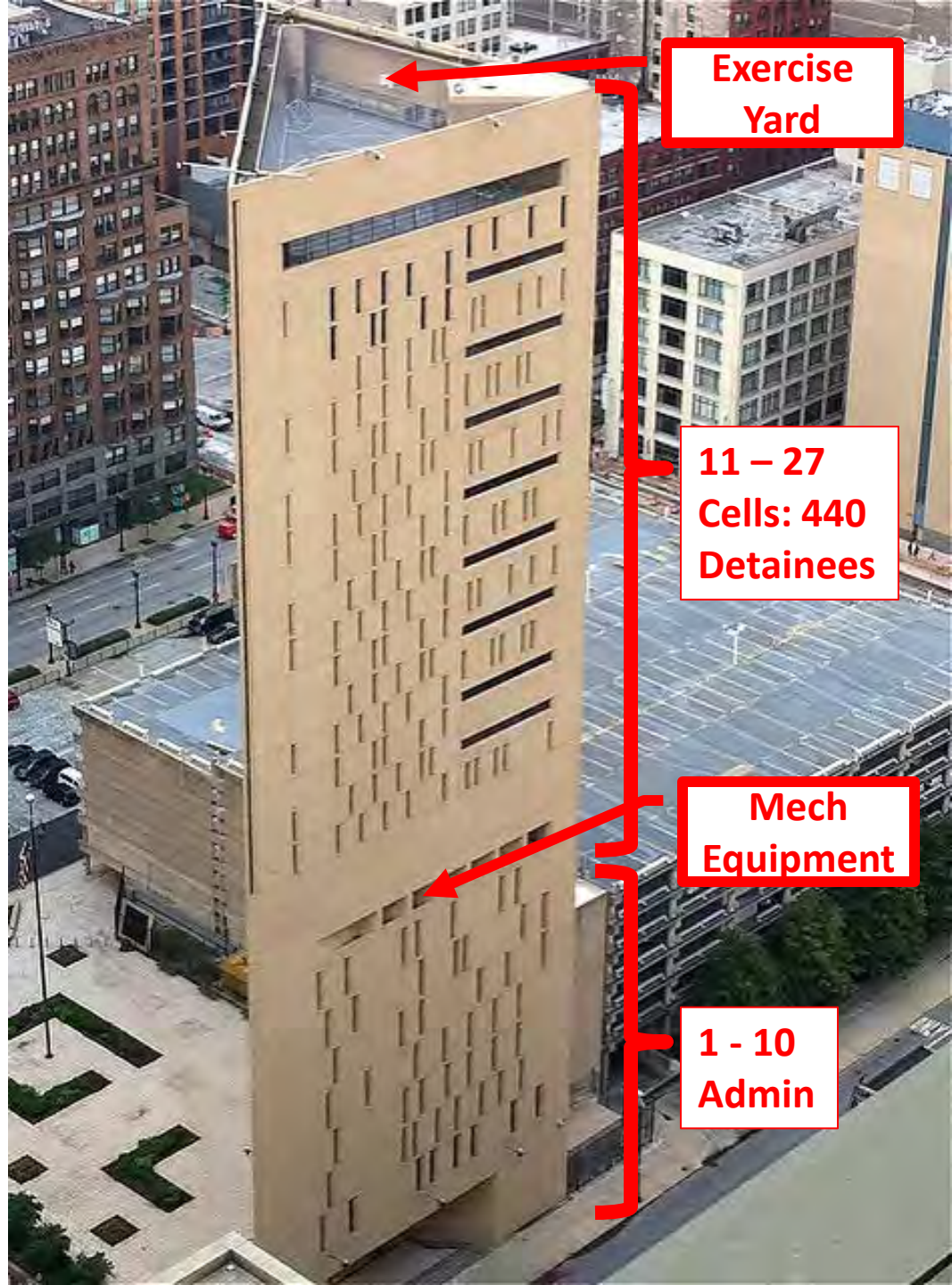
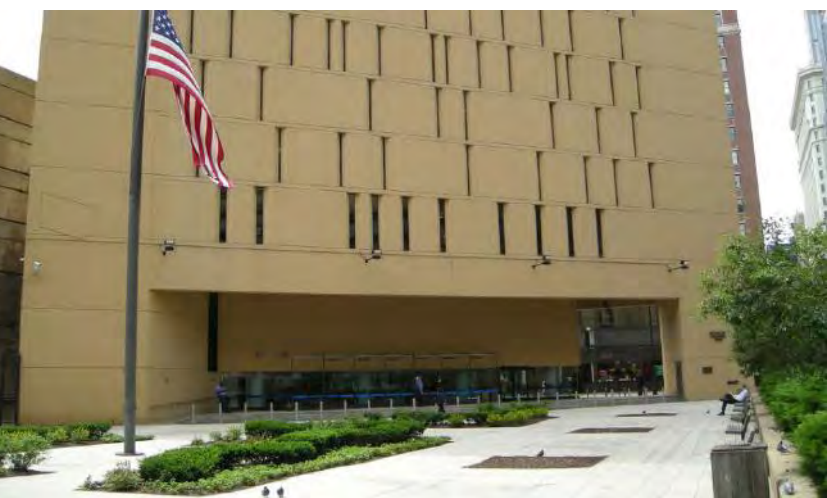



CHICAGO METROPOLITAN CORRECTIONAL CENTER

- 

Access to Natural Light

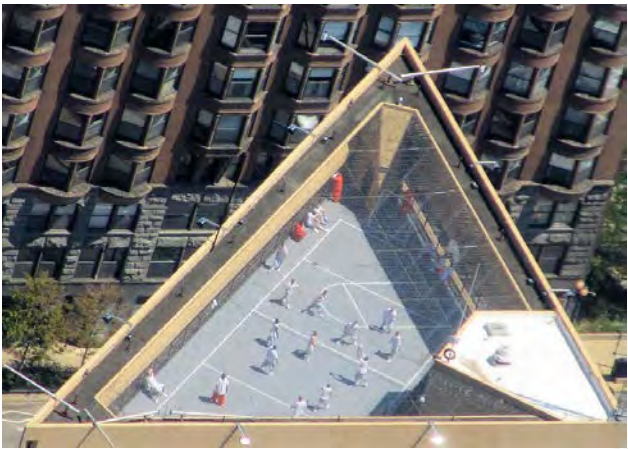
 - Relaxed state of detainees – easier to manage
 - Improved health outcomes
 - Compliance and cooperation
- 
 - Incidents of assault, bullying self-harm and suicide
 - Perception of building as welcoming and inclusive



- 

Direct Supervision

 - Communication between officers and detainees
 - Greater job satisfaction for Officers
 - Effectivity in managing and positively influencing detainees
- 
 - Fewer assaults between detainees
 - Less destruction of property by detainees

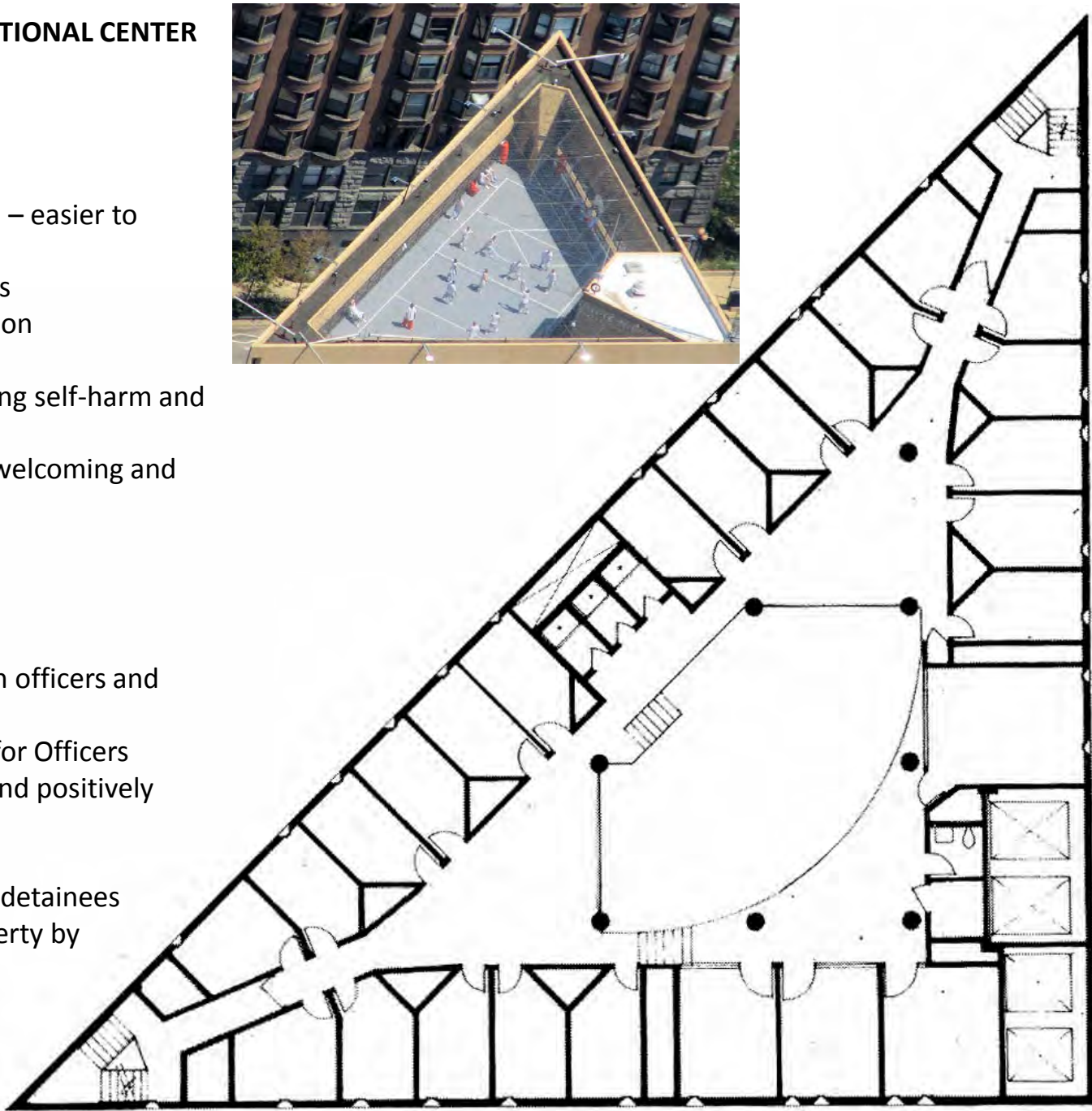

Ray, Leah. "Opposing Mies: The Triangular Constructs of Harry Weese." In Chicago Architecture: Histories, Revisions, Alternatives, edited by Charles Waldheim and Katerina Rüedi Ray.

AMSTERDAM-OVERAMSTEL: Netherlands, Amsterdam

- Opened in 1978 and closed in 2016
- 6 Towers and 6 outdoor areas – 14 Stories
- Towers connected by tunnel
- 2 Towers = Psychiatric use / 4 Towers = Pre-trial detention

Open, Multipurpose, Active

- Acceptance of incarceration
- Compliance and Cooperation
- Odds of violent incidents
- Buildup of aggression



SAN DIEGO METROPOLITAN CORRECTIONAL CENTER

- 23 Stories
- 1,300 detainees: 48 rooms per floor
- Decentralized concept: visiting, recreation, feeding, treatment programs on each floor



Decentralized Concept / Smaller Facilities

- Healthy relationships
- Purposeful activity
- Humane treatment of detainees
- Detainee rehabilitation
- Officer-detainee personal relationships
- Safety

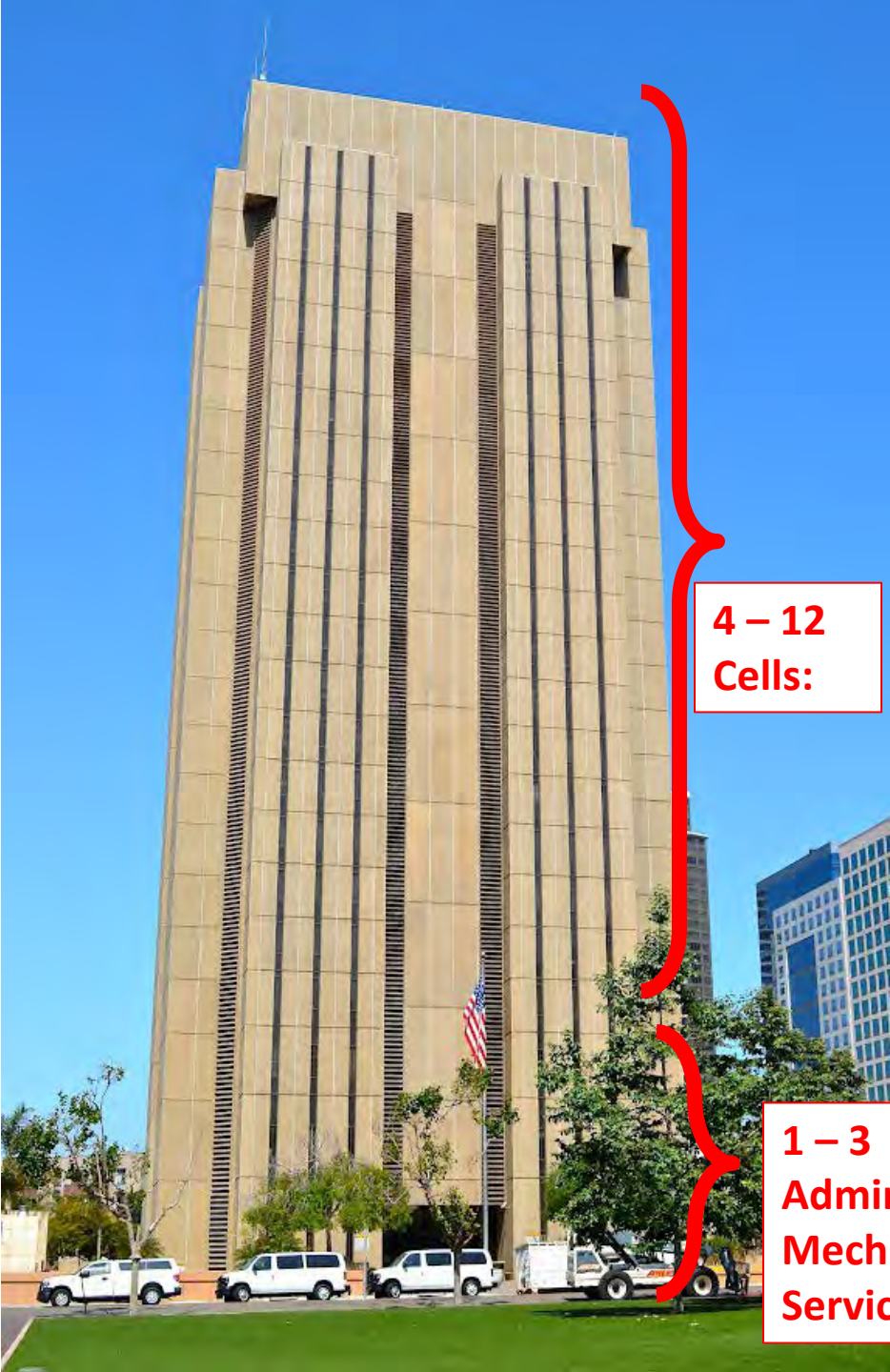

4 – 12
Cells:

1 – 3
Admin
Mech
Service



JUSTICE IN DESIGN

JUSTICE IN DESIGN TEAM

DAN GALLAGHER, AIA, NADAAA

NADER TEHRANI, NADAAA; DEAN, IRWIN S. CHANIN SCHOOL OF ARCHITECTURE AT THE COOPER UNION

SUSAN GOTTESFELD, OSBORNE ASSOCIATION

KAREN KUBEY, URBANIST

SUSAN OPOTOW, JOHN JAY COLLEGE OF CRIMINAL JUSTICE AND THE GRADUATE CENTER OF CUNY

JAYNE MOONEY, JOHN JAY COLLEGE OF CRIMINAL JUSTICE AND THE GRADUATE CENTER OF CUNY

**VAN
ALAN**

INSTITUTE

**The Independant
Commission for
New York City
Criminal Justice and
Incarceration Reform**





TOP: RIKERS ISLAND, 2011
AP PHOTO / BEBETO MATTHEWS

RIGHT: RIKERS ISLAND, 2015
AP PHOTO / SETH WENIG





2016 RALLY IN NEW YORK CITY
PHOTO BY [DAVID ETHERIDGE-BARTOW](#)

TEAM VALUES

Bring our collective imagination and skills to identify principles for urban jails and related programs.

During the PROCESS are:

- **attentive to the issues, concerns, and needs multiple stakeholders**
- **attentive to accessibility and safety**
- **utilize a process that is inclusive in all aspects: communication, planning, etc.**
- **consistent with ethical principles of our field**

Create OUTCOMES, that:

- **foster constructive connections between the institution of the jail and the context in which it is situated**
- **foster the wellbeing of people living and working in and visiting these institutions, including physical and mental health**
- **reduce violence and improve outcome**
- **attend to the role of the built environment in fostering caring and respectful connections among people**
- **provide a secure interface between the jail or detention center and the larger community while encouraging mutually-productive programmatic contacts between those inside and outside**
- **accommodate a wide variety of programmatic activities**
- **permit residents' and workers' contact with nature (e.g., visually, sensorily, or other ways)**
- **allow flexibility for future modifications**
- **teach those who live, work, visit, or are neighbors to the building, by visible example, about sustainable, efficient, through aesthetically engaging design**



WORKSHOP ATTENDEES:

**Fortune Society
mdrc
Bronx Connect
Osborne Association
Bronx Workforce
NYCHA
Friends of Island Academy
I-CAN
Nat'l Assoc of Social Workers
Just Leadership USA**

**Vera institute
Councilman Brad Lander
MOCJ
Center for NuLeadership on Urban Solutions
Black Alliance for Just Immigration
Cobble Hill Association
Willowtown Association
Community Coordinator for Felix Ortez
Atlantic Avenue Betterment Association
Metropolitan College
Councilman Levin's office
Legal Aid Society
Ricci Greene
Juvenile Justice
Raise the Age**

**New Haven Ministries
Center for Court Innovation
Innocence Project
Former Corrections Captain
Safe Horizon
Catholic Migration Services
Queens Family Justice Center
Queen Child Advocacy Center
Kew Gardens Civic Association
JASA
Station of Hope Ministry
CASES
Correction Officers Union**

**Psychologists
Doctors
Neighborhood Business Owners
Neighborhood Residents
Architects
Lawyers
Art Therapist**

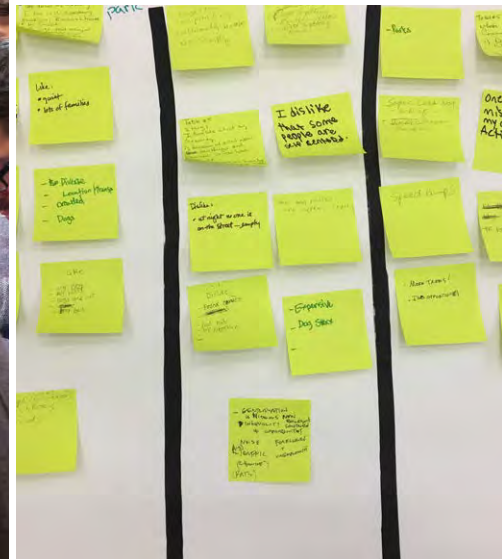

WORKSHOP PROCESS

THE RIKERS KNOT

Rikers Island affects people from every borough, creating intertwined challenges for detainees, their families, correction staff, and city residents. The isolated location, harsh environments, and challenging protocols make for spaces that are dehumanizing, unhealthy, and unsafe for many that come into contact with it. Closing Rikers would relieve the knot of tension and harm that these jails create.

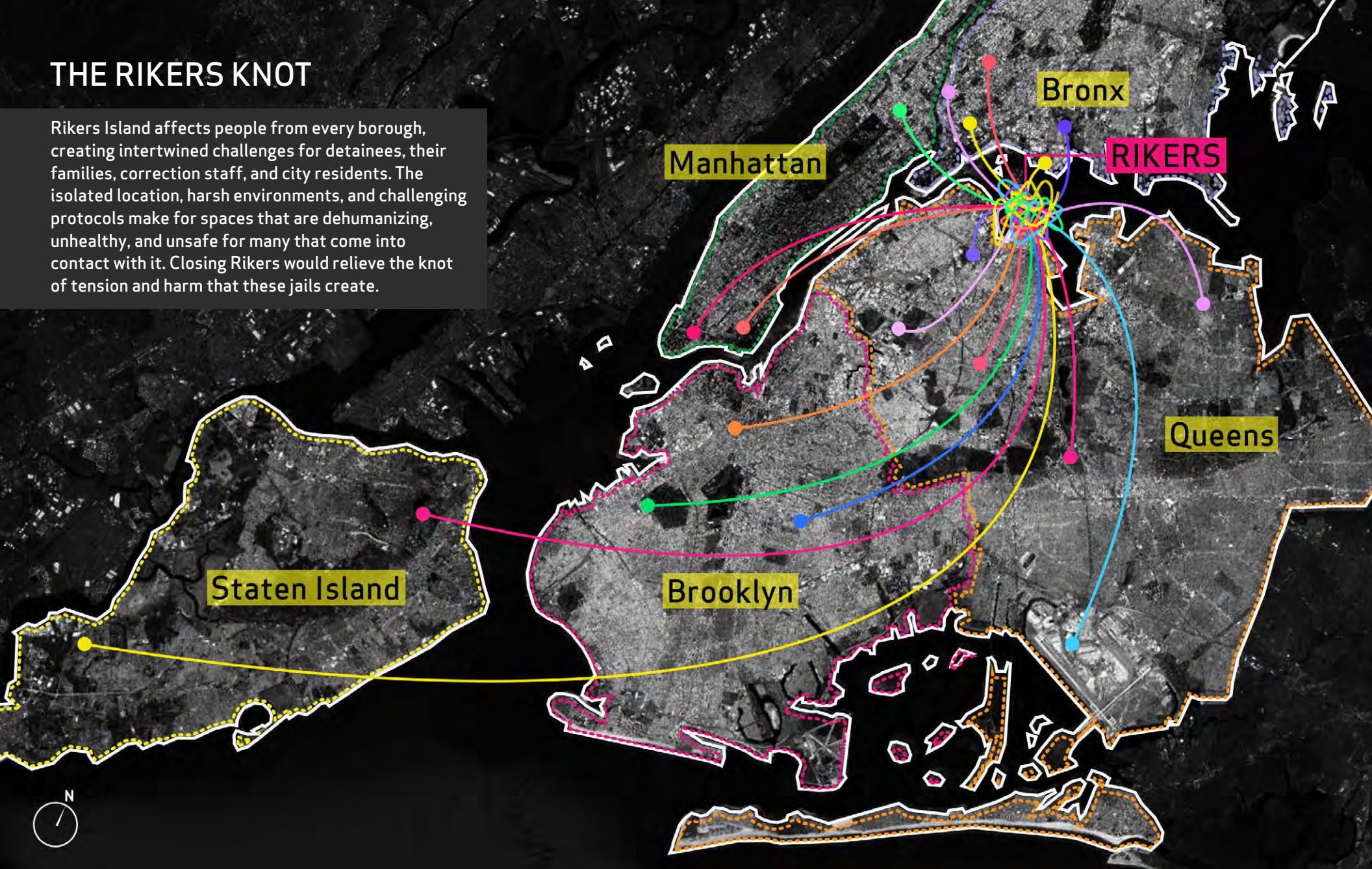



DESIGN PRINCIPLES AND OPPORTUNITIES
INTERIOR SPACES

MULTISTORY PODULAR LAYOUT WITH OUTDOOR SPACE

Direct Supervision
Day Room
Local Group Room
Adjacent Program Office
Video Connectivity Space
Dayroom With View
Program Area
Daylight & Air

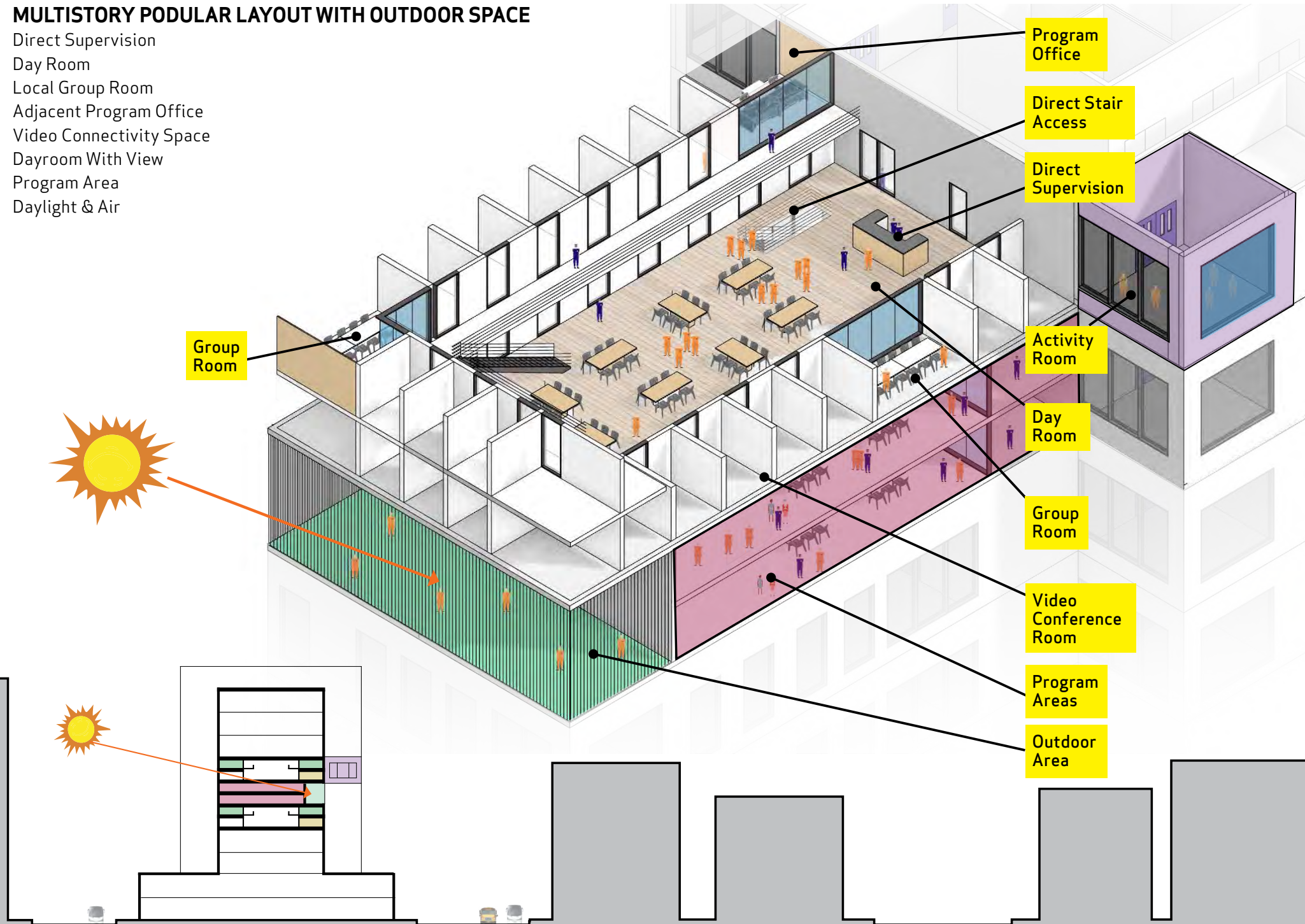

OFFICER & ACTIVITY BREAK SPACES WITH OUTDOOR SPACE

Material & Finish Varieties

Furniture Variety

Conference Room

Daylight & Air

Outdoor Space

Views

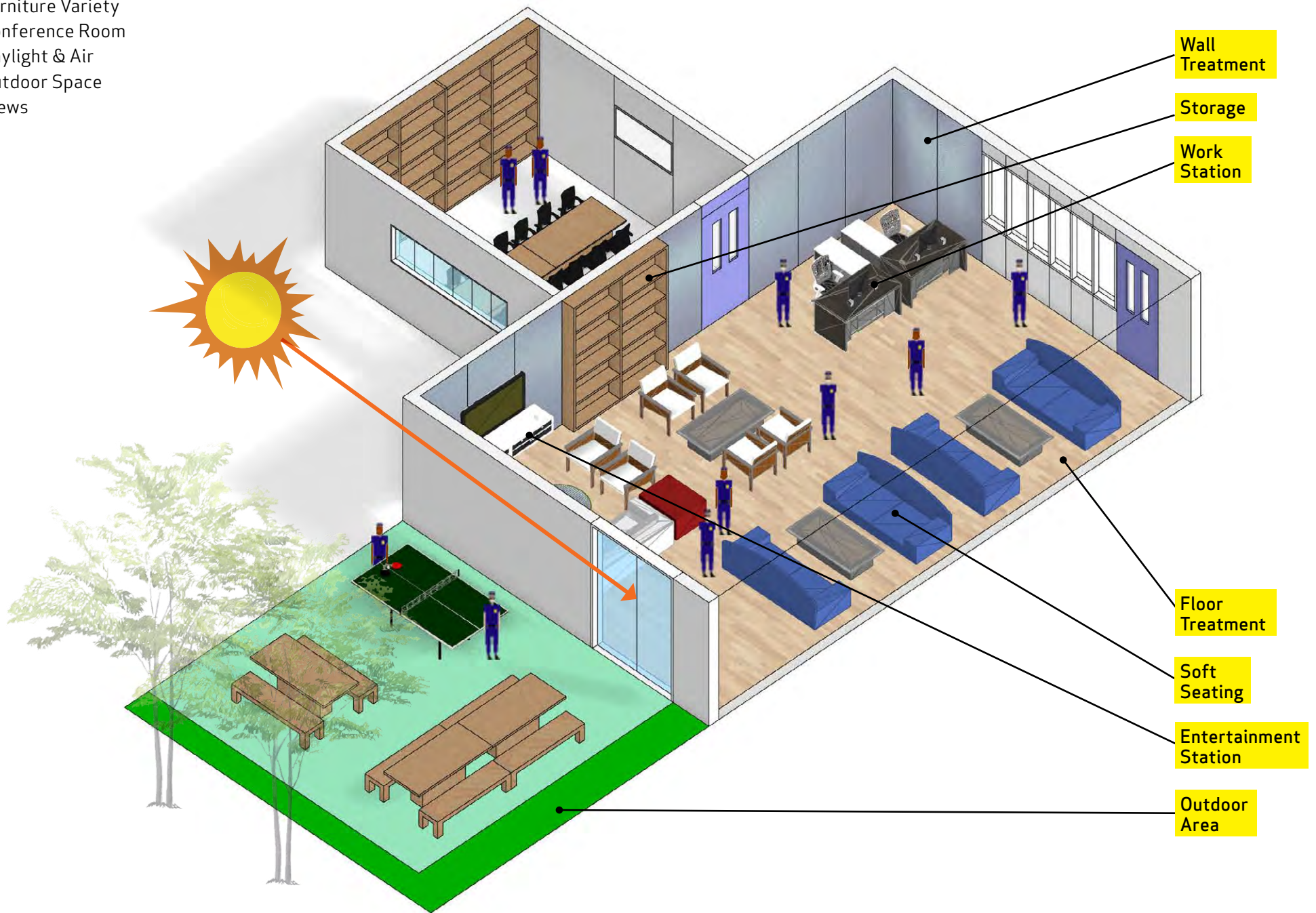

VISITOR EXPERIENCE

Material & Finish Varieties
Comfortable Space
Children's Area
Daylight & Air
Outdoor Area
Views

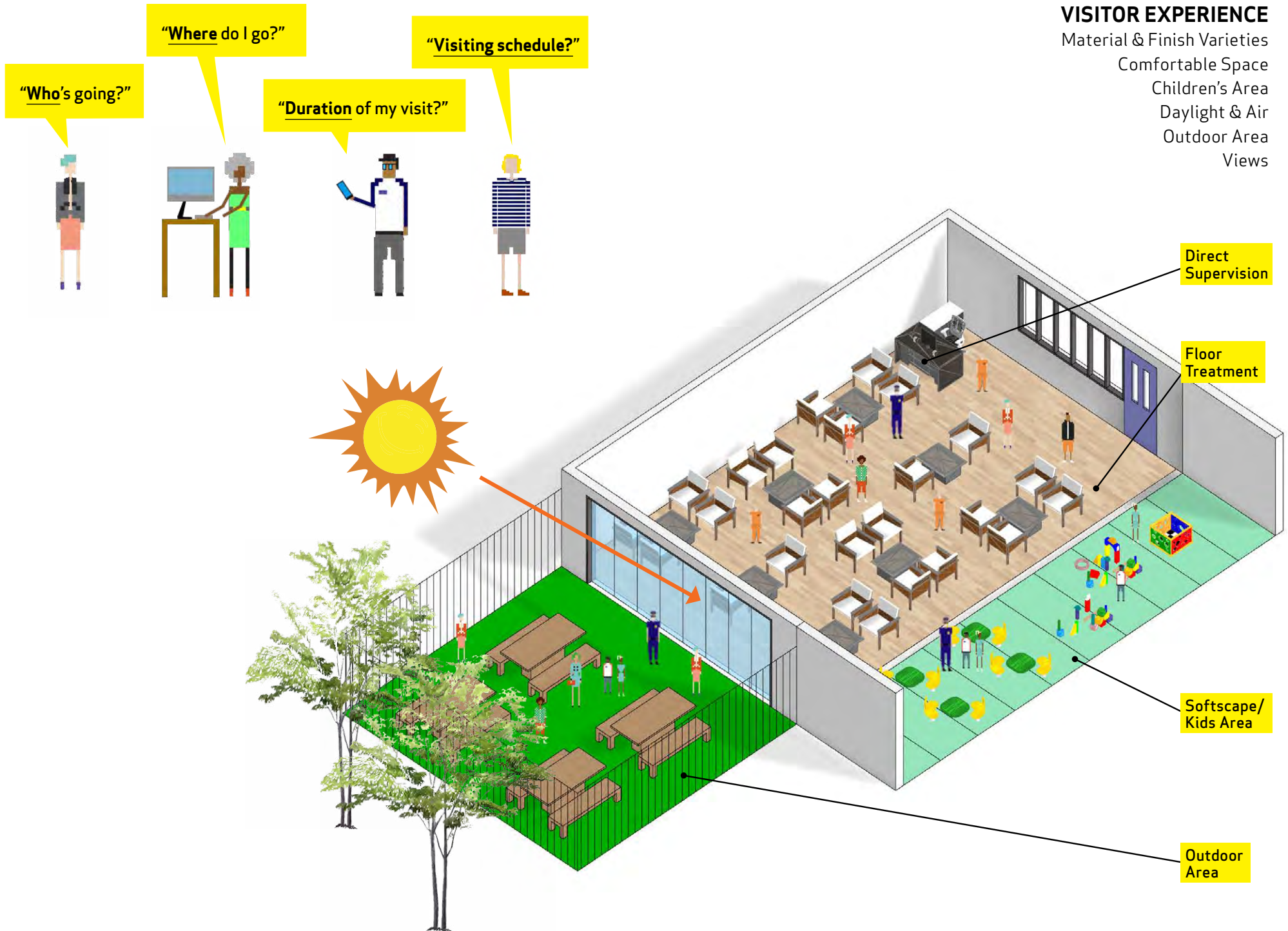

COMMUNITY CONNECTIONS AND THE CIVIC EXPERIENCE

JUSTICE HUBS

Justice Hubs are a new model for detention in New York City. Located in each of the boroughs near existing courts and municipal buildings, these new facilities offer an innovative opportunity for a justice system that is fair and responsive to different communities throughout New York City. Rikers Island is an isolated, violence-plagued, fiscal drain on the city. The Hubs' locations and state-of-the-art design offers:

1. Reduced time and resources needed for individuals to move to and from courts.
2. Modern facilities that are safe on the inside and reflect the look and feel of the neighborhood on the outside.
3. Increased accountability and community connection.
4. Improved court efficiency that eases strain on inmates and staff.
5. More effective and efficient programming and services that address mental health and criminal justice issues that ultimately lower the jail population.
6. The creation of a civic resource, integrated into the neighborhood providing communities with much needed services and facilities.

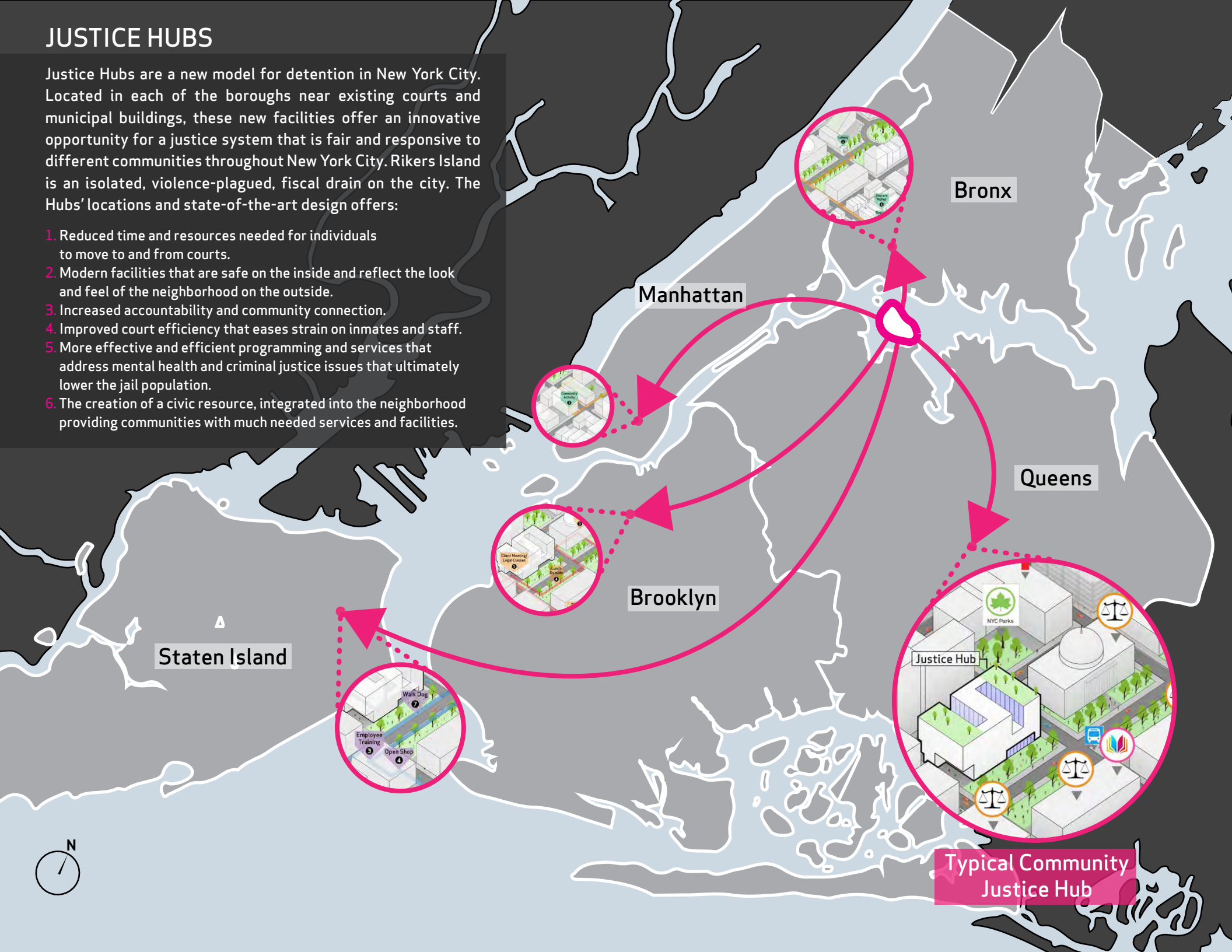

Bronx

Manhattan

Queens

Brooklyn

Staten Island

Justice Hub

Typical Community
Justice Hub

CITY PEOPLE / DIVERSE NARRATIVES

Communities are defined by a diversity of people utilizing an array of places and programs in the City. The location, programming and services provided at a Justice Hub will benefit detainees, their families, jail staff and the broader community.

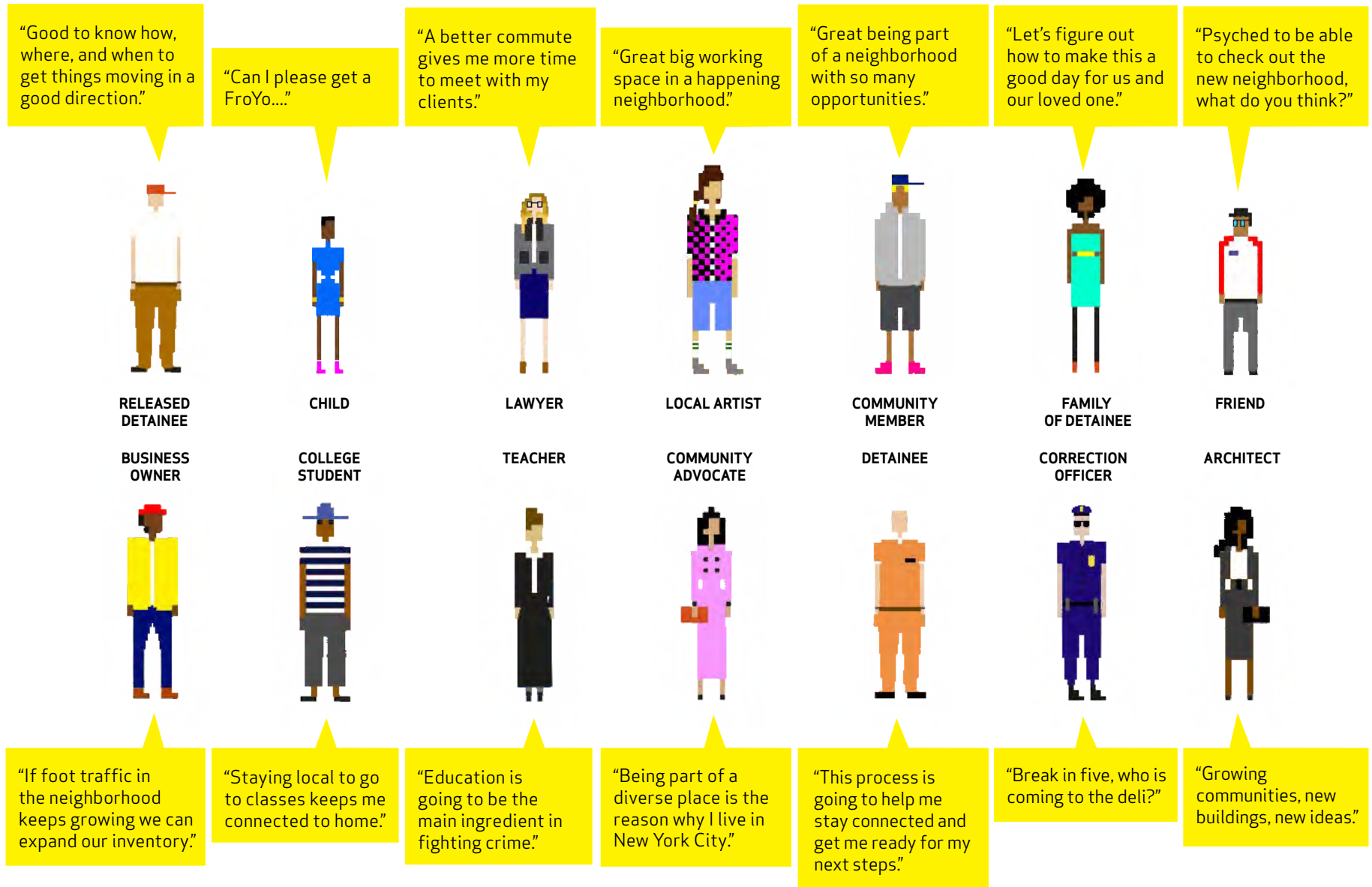

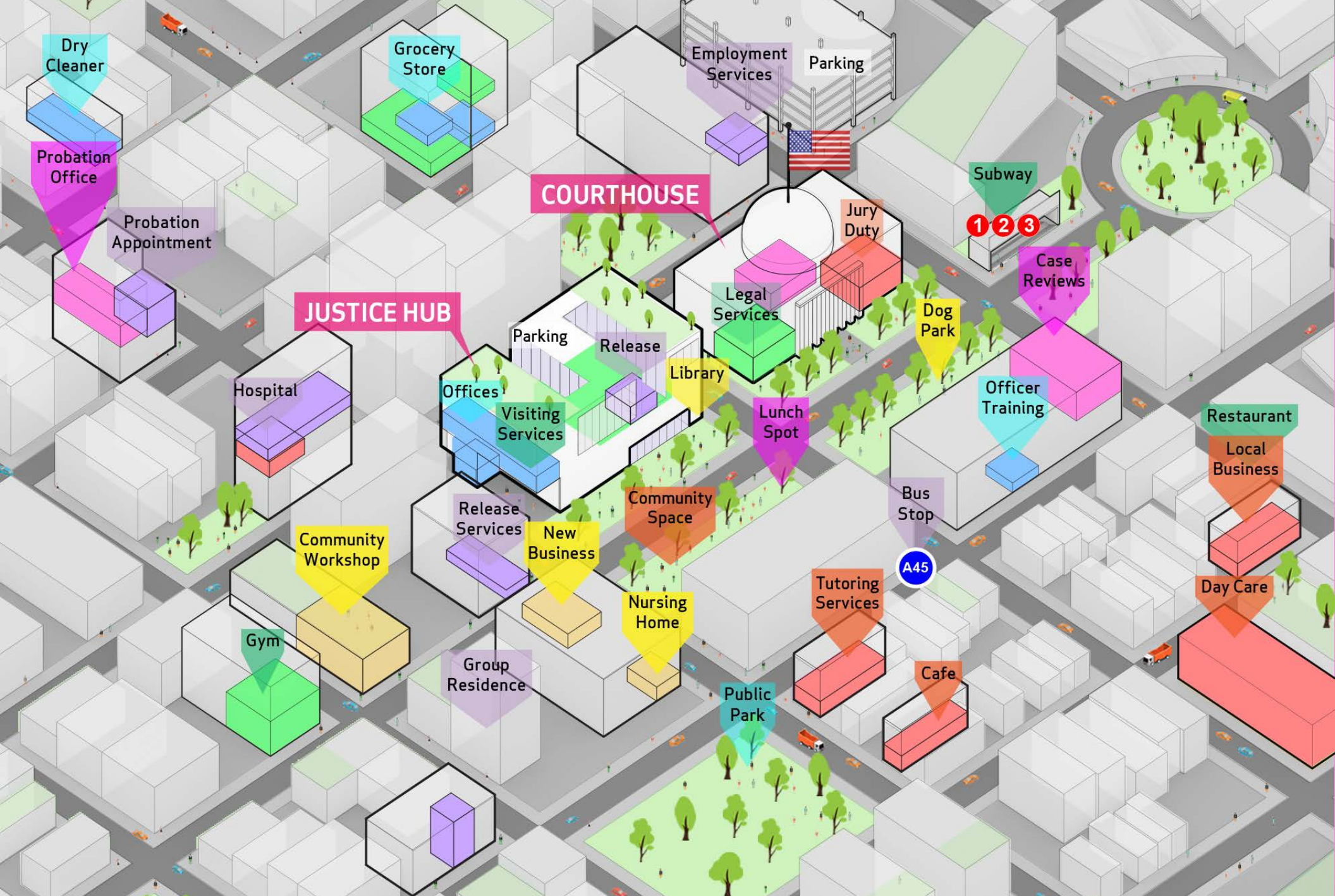

The Justice Hub offers a diversity of opportunities in the neighborhood and fosters healthy experiences. Its presence in the community enables a higher standard of local accountability for the criminal justice system. It not only supports a more just and efficient judicial process, but cultivates positive civic identity and understanding.

CITY LIVING: A DAY IN THE LIFE

DETAINEE

"This process is going to help me stay connected and get me ready for my next steps."



A **Justice Hub** benefits the detainee by providing a faster judicial process, better access to health services and programming, more frequent access to family visits and legal support, and more calming living spaces.

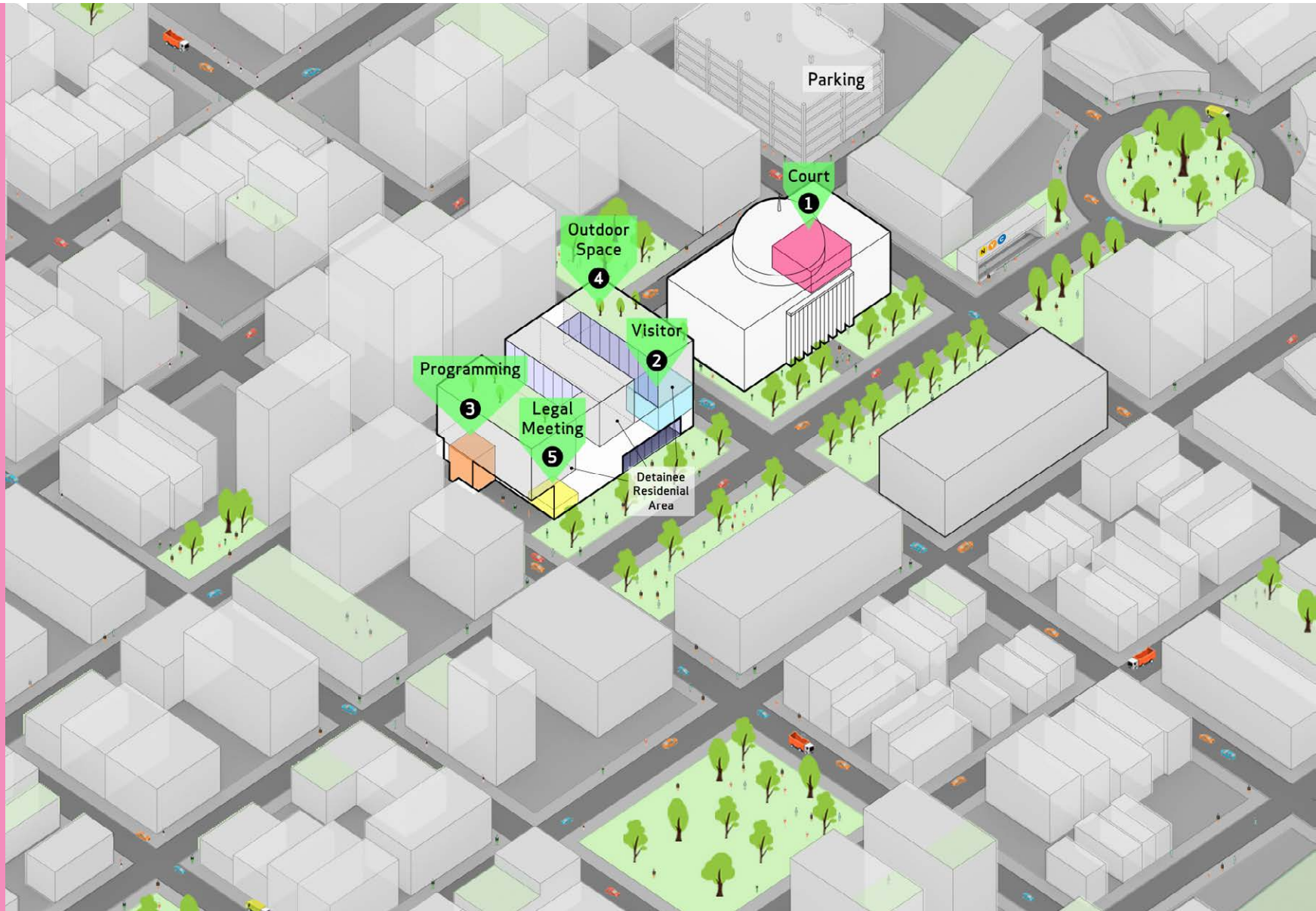

CITY LIVING: A DAY IN THE LIFE

COMMUNITY MEMBER

"Great being part of a neighborhood with so many opportunities"



A **Justice Hub** benefits community members by offering new programming spaces and public services.



CITY LIVING: A DAY IN THE LIFE

CORRECTION OFFICER

"Break in five, who is coming to the deli and eating outside?"



A **Justice Hub** is more accessible to officers, providing dedicated parking, safer work spaces, and access to local amenities.

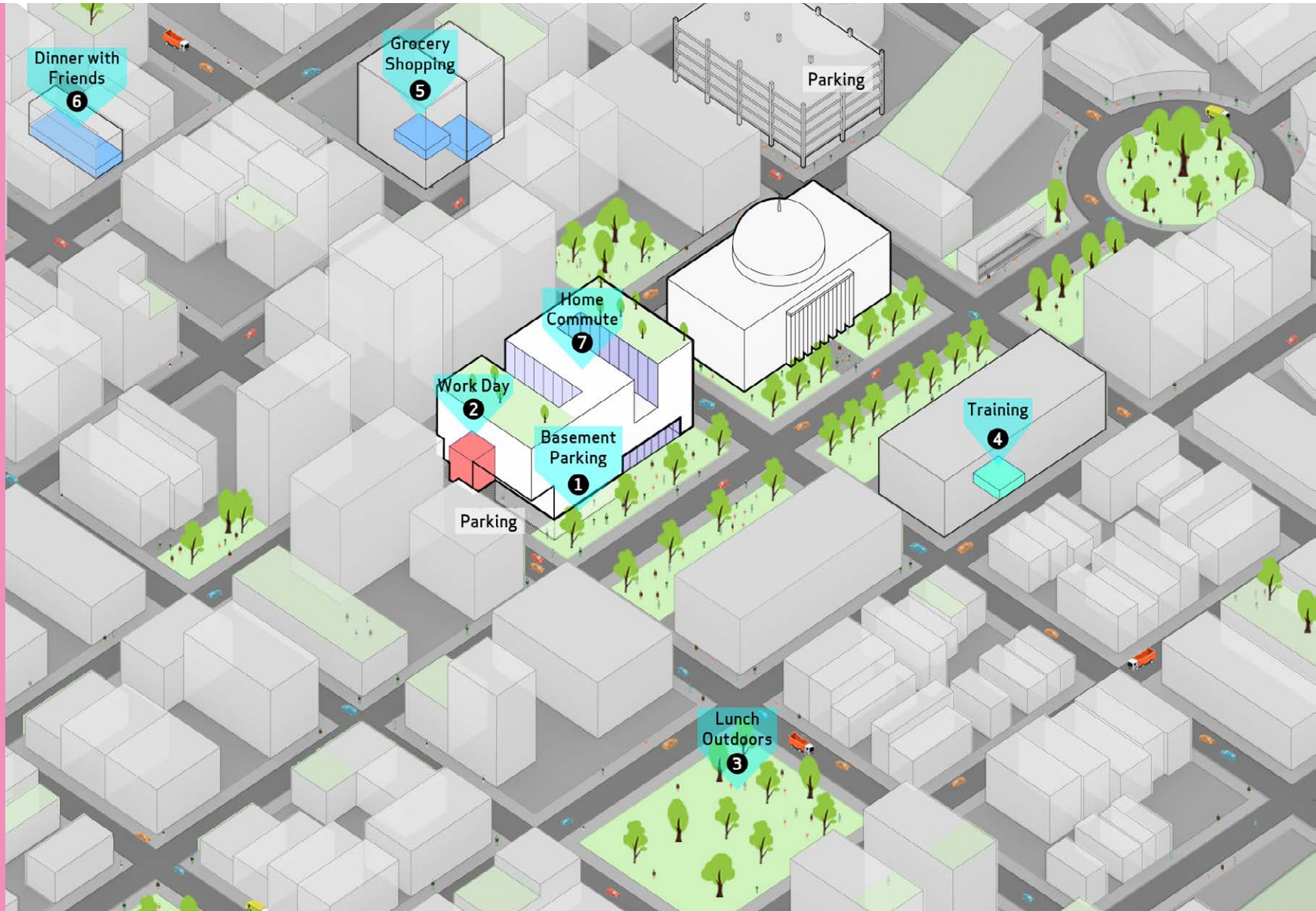

CITY LIVING: A DAY IN THE LIFE

BUSINESS OWNER

"If foot traffic in the neighborhood keeps growing we can expand our inventory"



A **Justice Hub** makes all public infrastructure an integrated part of the community, catalyzing more economic opportunity through the jobs it creates and the new public space it offers. Thereby becoming a benefit to local community members and business owners.

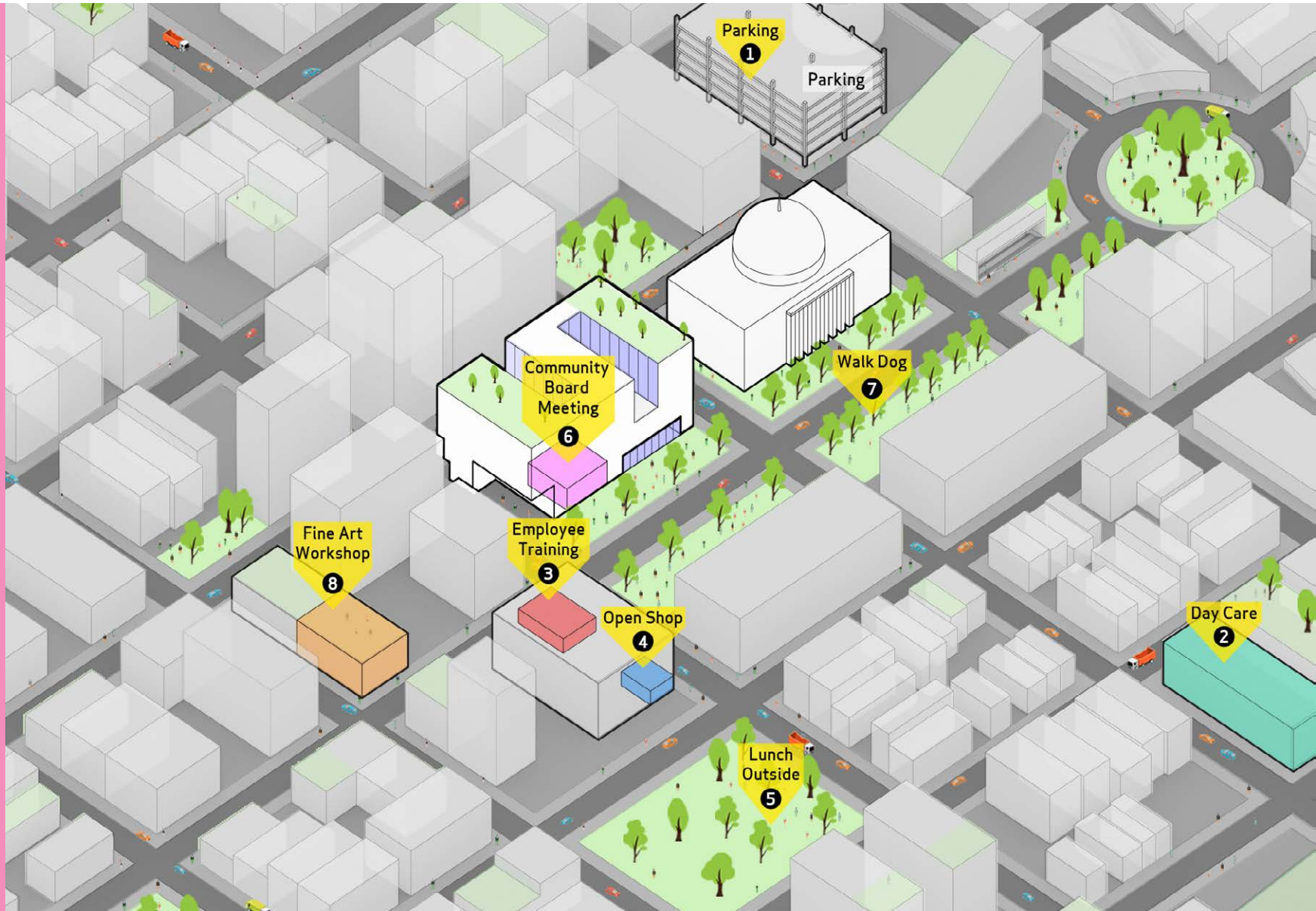

CITY LIVING: A DAY IN THE LIFE

FAMILY OF DETAINEE

"Let's figure out how to make this a good day for us and our loved one."



A **Justice Hub** enables family members of detainees and inmates the opportunity to see loved ones without traveling long distances, and creates a safe and friendly environment for visitation.



CITY LIVING: A DAY IN THE LIFE

RELEASED DETAINEE

"Good to know the how, where, and when to get things moving in a good direction."



A **Justice Hub** benefits a released detainee by offering a supportive community and network of services for rehabilitation.

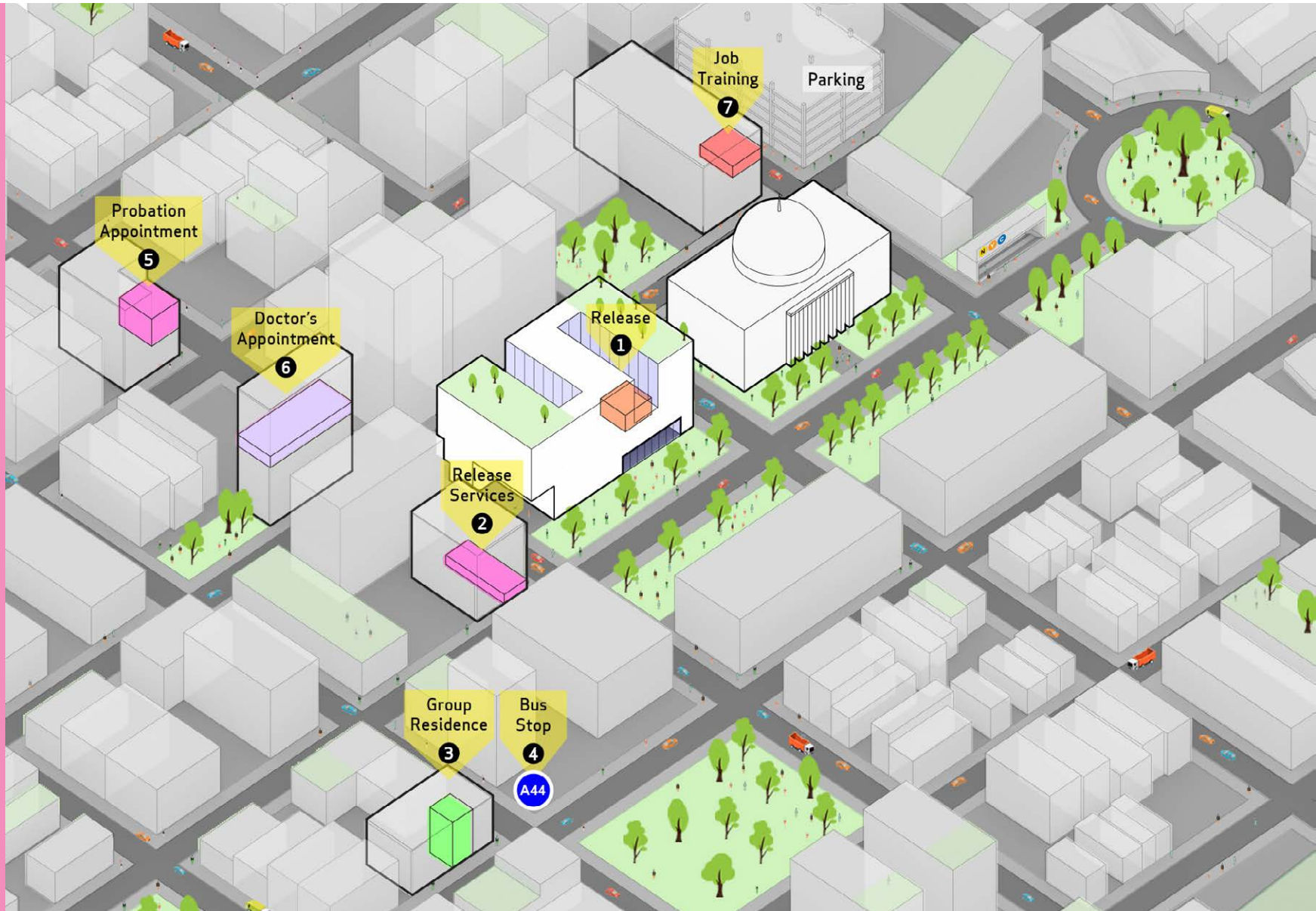

CITY LIVING: A DAY IN THE LIFE

LAWYER

"A better commute gives me so much more time to help my clients."



A **Justice Hub** benefits legal professionals by affording more direct and productive access to clients, courts, programs, and activities.

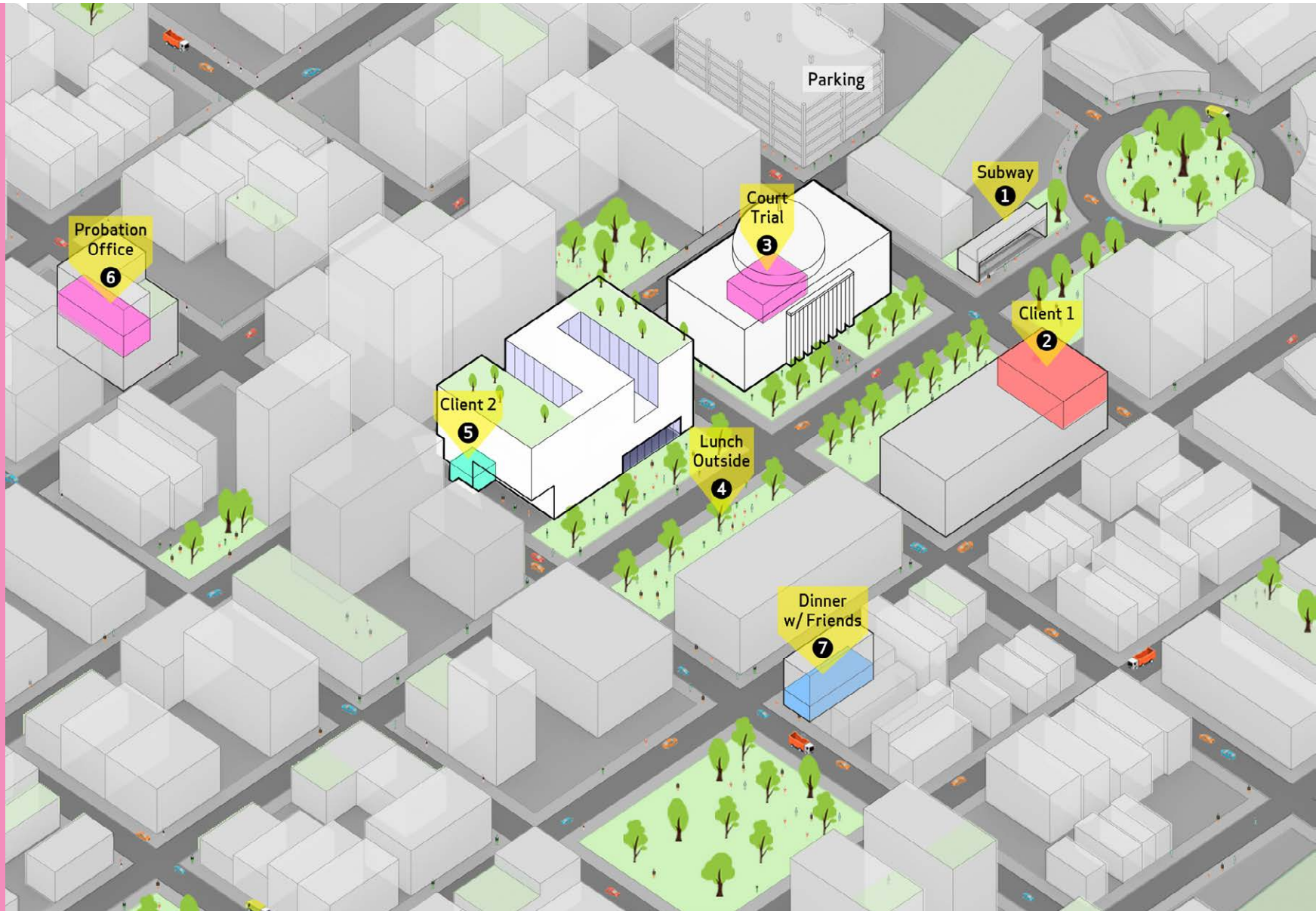

CITY LIVING: A DAY IN THE LIFE

People engage city elements in specific ways and share coincidental connections. Realizing our connectedness can help shape a positive understanding of who we are and how we define New York City.

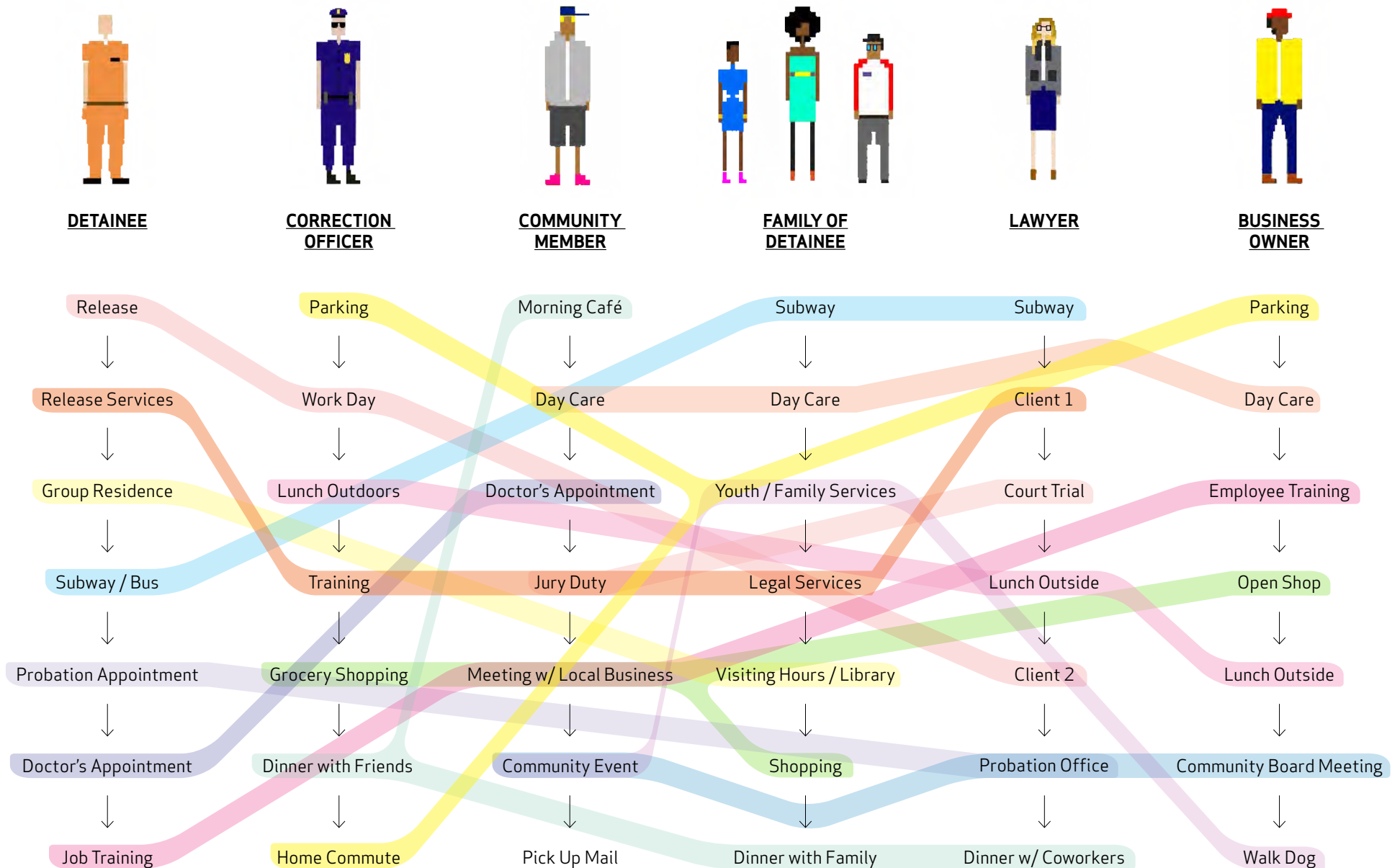



JUSTICE HUB IN THE CITY

A building in proximity to
courts and other civic uses

JUSTICE HUB IN THE CITY

A building open and inviting to
all with programs to benefit all
aspects of the community

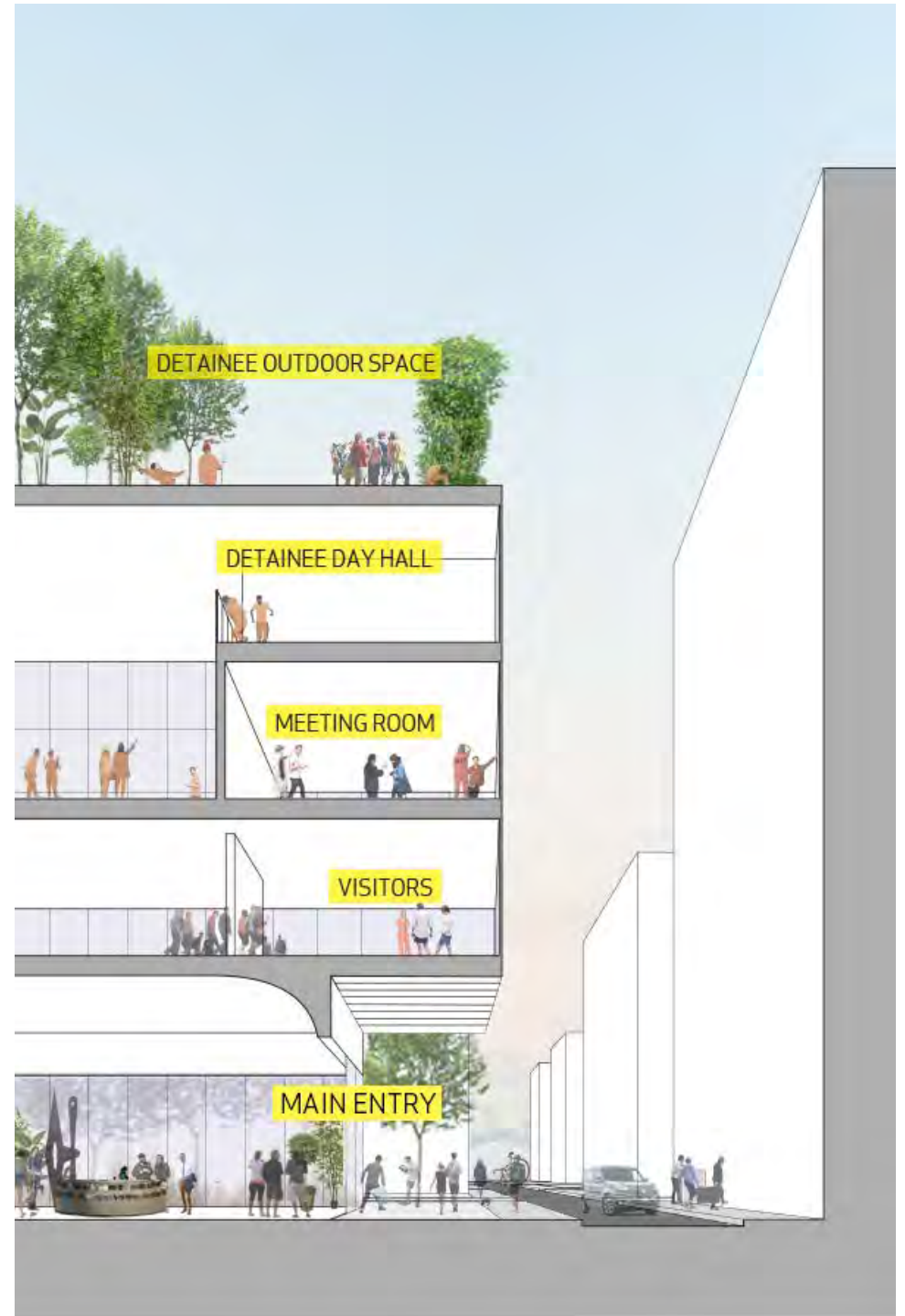

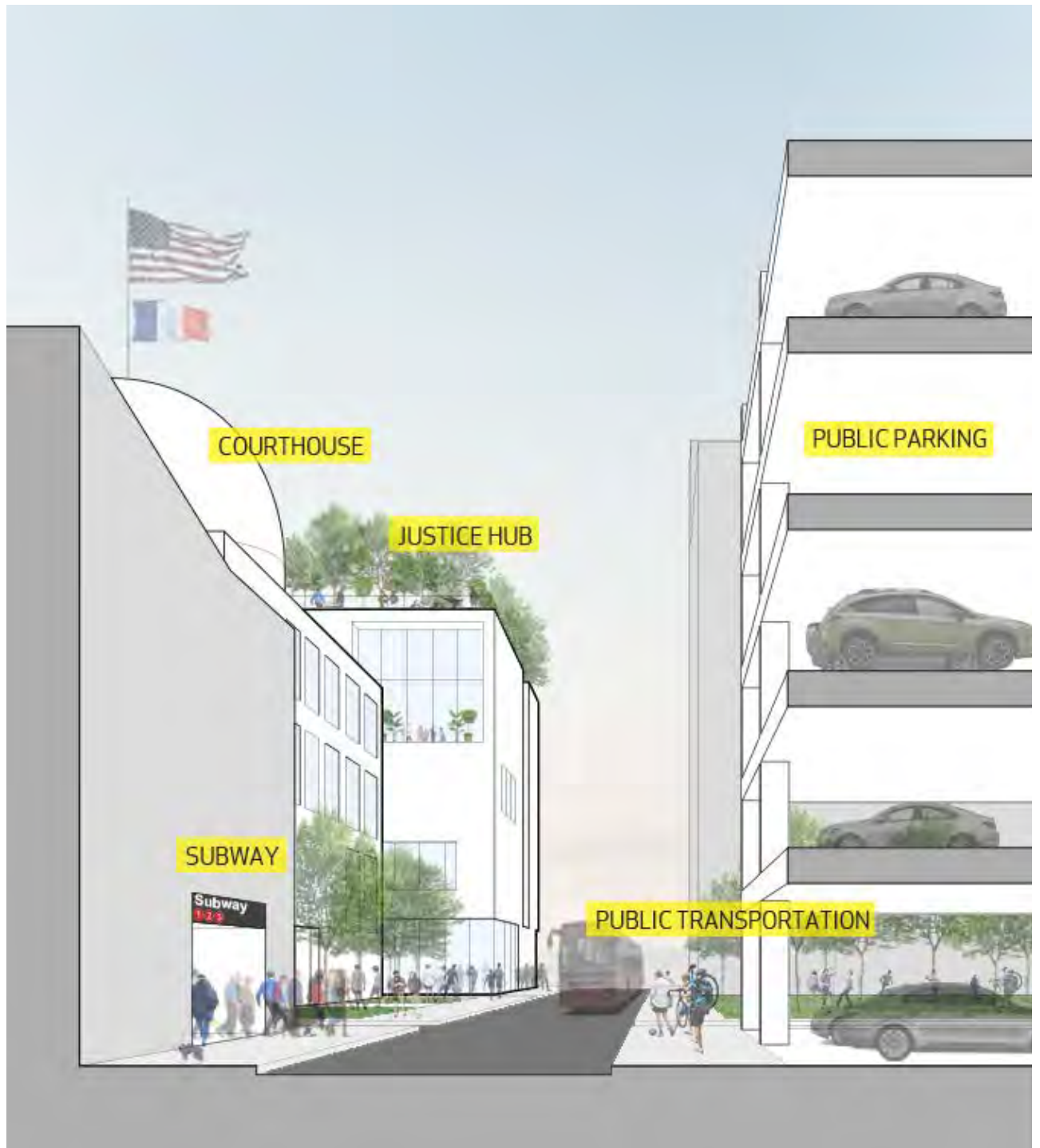

Section indication subway entrance, parking garage, Justice Hub, and courthouse

CITY LIVING / CIVIC CONNECTIONS

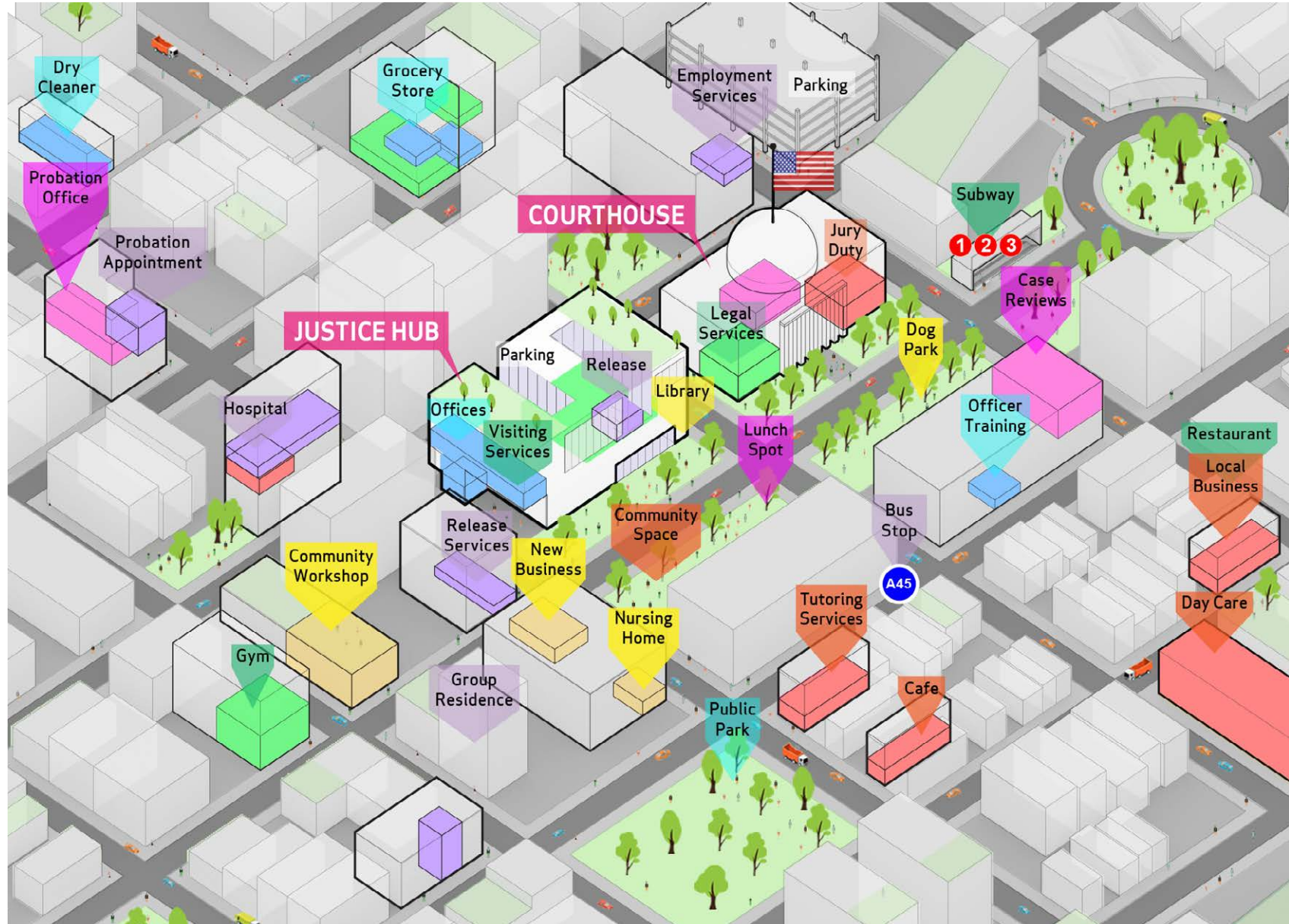
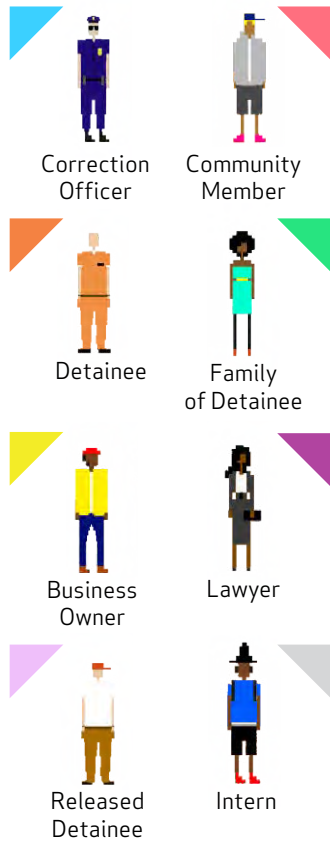

CONCLUSION
IMPERATIVE FOR CHANGE

Perceptions of Jails

What is your perception of the experience jail has on an individual?

Inside

- ① dehumanizing
- ② designed to break
- ③ ~~down~~ abusive
- ④ makes you highly dependent (on basic needs)
- ⑤ depressing, disrespectful
- ⑥ unsanitary

Outside

- ③ Lack of employment
- ④ Lack of opportunities
- ⑤ No direction
- ⑥ System expects you to fail

Working in / Visiting

- ② Dehumanizing
- ③ Blaming ^{blame} Society
 - because family look like Criminal
- ④ Sexual Abuse

What design features contribute to this?

- cells (clades)
- metal ring (riders)
- basic needs are not met
- parent walls

What design opportunities could make the experience better?

- ② Improve Tdets
- ③ Single occupancy cells
- ④ more space
- ⑤ educational programs
- ⑥ No out-buff age
- ⑦ Programming (unavailable)

A photograph of two women standing in front of a large mural. The mural features the text 'WE DON'T KNOW WHAT FOREVER IS' in large, light blue, hand-painted capital letters on a yellow background. The woman on the left is wearing a red and black top and a black headscarf, and is gesturing with her hands while speaking. The woman on the right is wearing a dark blue top and a white and blue patterned scarf, and is looking down.



Agenda

1. Introduction (10 minutes)
2. Presentation: best practices in facilities design (40 minutes)
3. **Discussion (35 minutes)**
4. Closing and next steps (5 minutes)

Discussion

- How do these concepts implicate our work in New York City?
 - Which concepts are most applicable?
- One of this group's deliverables is a recommendation on design principles to inform a borough-based jail system. Based on what we know today, what do we think are important design principles?
- What else do we need to know?

Agenda

1. Introduction (10 minutes)
2. Presentation: best practices in facilities design (40 minutes)
3. Discussion (35 minutes)
4. **Closing and next steps (5 minutes)**